

**KEGMAS<sup>TM</sup>TER**

*Kegerator Range*



**Installation Guide**

**Designed & Engineered by Keg King**



## WARNINGS

**⚠ Beware of electricity around liquids! Ensure power cords are placed well away from any potential spills and pooling condensation.**

**⚠ DO NOT power up the refrigeration unit until it has rested upright for 24 hours. Failure to do so will void the Warranty!**

**⚠ The refrigerator needs 50mm clearance around any compressors, condensers, and vents. Failure to do so will void the Warranty!**

**⚠ Leaking CO<sub>2</sub> gas can cause suffocation.  
Always use CO<sub>2</sub> in a well-ventilated open area, in case leaking occurs.  
Never exceed gas pressures of 40psi with your kegs system.**

**⚠ This refrigeration unit may require occasional manual defrosting.  
DO NOT scrape any ice or frost from the inside walls or cold plates.  
Doing so may damage the unit and void the Warranty!**

**⚠ These refrigerators are for indoor and well sheltered outdoor installations**



**Please read the entire manual before operating.**

# Table of Contents

Keg King.....	4
Introduction.....	5
KegMaster™ Super Deluxe Kegerators.....	6
Standard Features.....	6
Installation Space Requirements.....	6
Single Door Model 7713.....	6
Double & Triple Door Models 7714, 7715 & 7716.....	6
Super Deluxe Single Door - Model 7713 .....	7
Model Specific Features .....	7
Specifications .....	7
Schematics.....	8
Super Deluxe Double Door - Model 7714 .....	9
Model Specific Features .....	9
Specifications .....	9
Schematics.....	10
Super Deluxe Double Door XL - Model 7715.....	11
Model Specific Features .....	11
Specifications .....	11
Schematics.....	12
Super Deluxe Triple Door – Model 7716.....	13
Features: .....	13
Specifications .....	13
Schematics.....	14
Optional Items.....	16
Modular Font Kits.....	16
Schematics.....	17

# Keg King



Whether you're a brewer or someone wanting to put drinks on tap in your own home, cafe or office, Keg King offers beverage creation and keg dispense solutions for amateurs and pros!

We don't just sell products, we innovate, design and manufacture our equipment to bring your beverage ambitions to life!

Our brands include:

- King Kegs, our Australian Made P.E.T. kegs
- Apollo P.E.T. Pressure Fermenters & Unitanks
- KegMaster™ Kegerators
- Atomic 15 Brewery Cleaners
- UltraTap Twist FC Faucets
- Spundy spunding valves
- the KegMaster™ Solstice Fridge
- and more!

Check the resellers map on our website to find where our products are available in North America, UK, EU, Aus, NZ and South Africa.

<https://www.kegking.com.au/retailers>

Since 2009, Keg King's mission is to make the best brewing & dispensing equipment in the world!

Check out our helpful instructional videos on the **Keg King YouTube Channel**

<https://www.youtube.com/c/KegKingvideos>

Enjoy your KegMaster™ Kegerator!



## Introduction

Welcome to the Keg King Australia range of kegerator and bar dispense equipment. Our products and appliances provide commercial and home bar owners with innovative design and powerful operating control. Our line of equipment includes the KegMaster™ Super Deluxe range of Kegerators, the KegMaster™ Series 4, the KegMaster™ XL Kegerators and our newest addition (2022) the KegMaster™ Solstice Dual Stage Kegerators.

This Product Installation Document will provide you with the information required to install Keg King Kegerator Appliances properly and safely in custom cabinetry. Elevations, port locations, dimensions, and recommended space requirements for safe operation are outlined here for your convenience.



# KegMaster™ Super Deluxe Kegerators

Super Deluxe is the highest end commercial grade, under counter, keg fridge you can find. Perfect for use within Australia because Super Deluxe fridges have an ambient working temperature up to 43°C.

## Standard Features

- Stainless steel exterior and interior (304SS internal and 430SS external)
- Dixel digital controller
- Heavy duty Embraco compressor with environmentally friendly R600a refrigerant
- Slide out compressor assembly for easy maintenance
- Stainless steel drip trays with drainage.
- Font ports for optional tap fonts (not included)
- Font hoses and adapters for keeping taps and fonts cool
- Gas line ports for external CO2 cylinders
- Recessed door handles
- Magnetic door gaskets
- Door locks
- Pre-installed castors
- Operational ambient temperatures are between +10°C to +43°C

## Installation Space Requirements

The Keg King KegMaster™ Super Deluxe commercial grade fridges generate heat around the compressor (bottom left-hand side for 2 & 3 door units) when cooling. This heat needs to be dissipated and if the heat is trapped it could potentially overheat the unit and trigger compressor failure. Good ventilation is necessary for the longevity of the unit. Please note that the following clearance requirements are a necessity and failure to meet those requirements could void the warranty. **Please also refer to the Plan View diagrams for your particular model.**

### Single Door Model 7713

- 50mm clearance required for the back and both sides of the fridge.
- No clearance required for the top.
- No clearance required for the bottom of the fridge however it is recommended for the fridge to be elevated off the ground for moisture to dissipate.
- If the unit is installed in an enclosed space behind doors, the doors must have vents and clearances must be respected. In this case, a minimum front clearance of 50mm is required.

### Double & Triple Door Models 7714, 7715 & 7716

- 50mm clearance required for the left-hand side of the fridge.
- No clearance required for the top.
- No clearance required for the right-hand side.
- No clearance required for the back of the fridge providing that the rubber spacers are not removed.
- No clearance required for the bottom of the fridge however it is recommended for the fridge to be elevated off the ground for moisture to dissipate.
- If the unit is installed in an enclosed space behind doors, the doors must have vents and clearances must be respected. In this case, a minimum front clearance of 50mm is required.

# Super Deluxe Single Door - Model 7713

## Model Specific Features

- One countertop font port for an optional tap font
- A single recessed drip tray with drainage

## Specifications

<b>Packing Dimensions:</b>	Width: 650 mm Depth: 861 mm Height: 1190 mm Weight: 85 Kg
<b>External Dimensions:</b>	Width: 585 mm Depth: 791 mm, 1345 mm with doors open Height: 998 mm
<b>Internal Dimensions:</b>	Width: 485 mm Depth: 500 mm Height: 780 mm
<b>Weight:</b>	60 Kg
<b>Capacity:</b>	200 L 1 x 50L keg (commercial) or 4 x 20L kegs (homebrew)
<b>Power:</b>	300W
<b>Voltage:</b>	220-240V 50Hz
<b>Current:</b>	1.6A
<b>Working Temperature:</b>	0 to 10°C
<b>Ambient Temperature:</b>	43°C
<b>Climate Class:</b>	SN-T
<b>Refrigerant:</b>	R600a (80g)
<b>Insulation Gas:</b>	Cyclopentane



*Taps and Font not included*

## Schematics

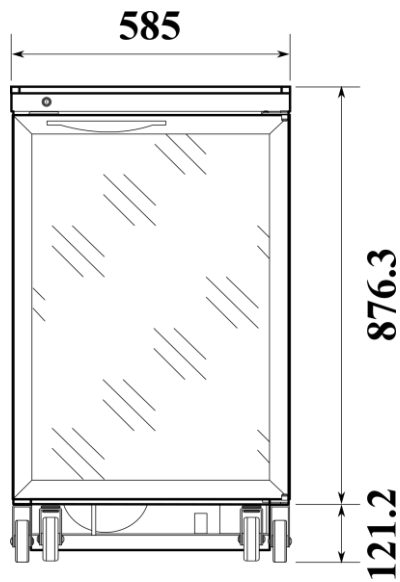

Single Door Front View

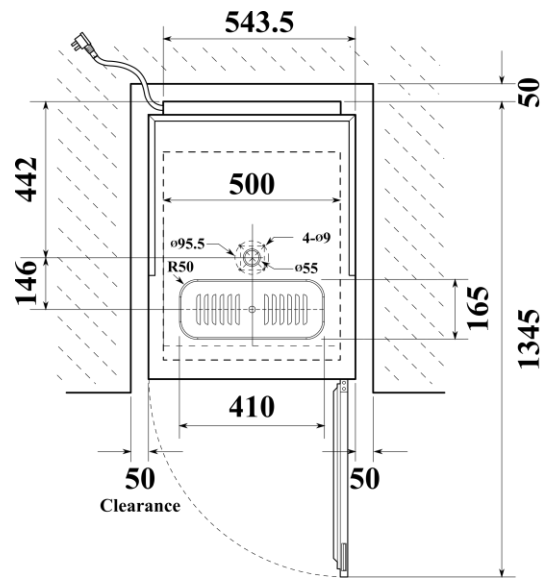

Single Door Plan View

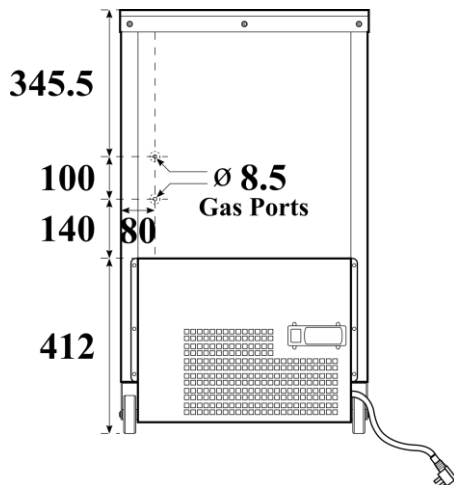

Single Door Rear View

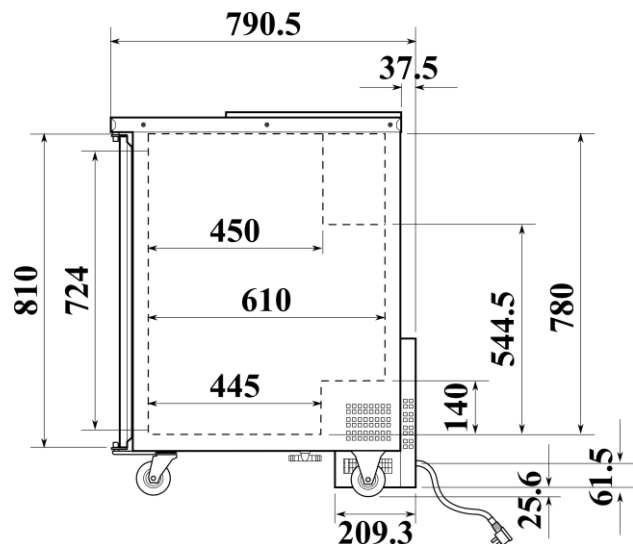

Single Door Side View

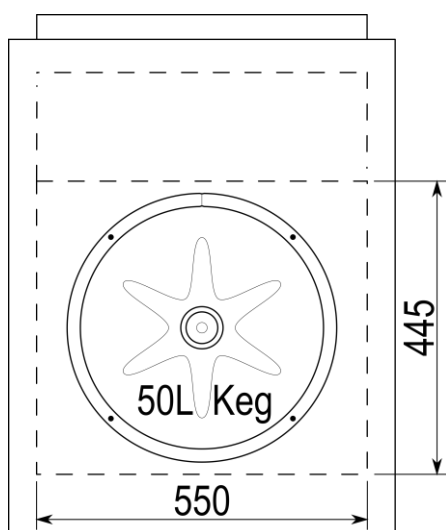
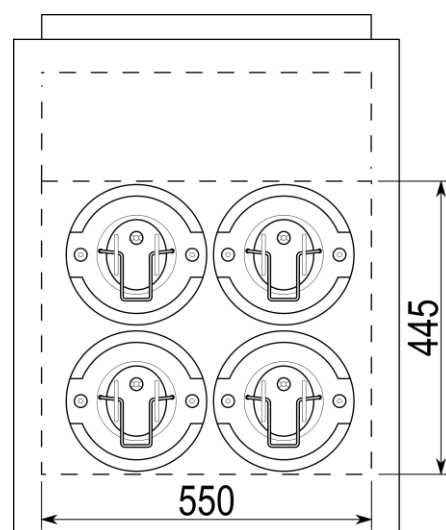
Single Door Capacity  
1 x 50L Commercial KegSingle Door Capacity  
4 x 19L Homebrew Kegs



# Super Deluxe Double Door - Model 7714

## Model Specific Features

- One countertop font port for an optional tap font
- A single recessed drip tray with drainage
- Two gas ports located on the right side
- Mountings for optional shelves (e.g. for packaged beverages)
- Interior lighting

## Specifications

<b>Packing Dimensions:</b>	Width: 1530 mm Depth: 765 mm Height: 1150 mm, Weight: 110 Kg
<b>External Dimensions:</b>	Width: 1467 mm Depth: 713.5 mm, 1270 mm with doors open Height: 942 mm, 1067 mm including castors
<b>Internal Dimensions:</b>	Width: 1092 mm Depth: 550 mm Height: 819 mm
<b>Weight:</b>	95 Kg
<b>Capacity:</b>	490 L 2 x 50L kegs (commercial) plus gas cylinder or 10 x 19L kegs (homebrew) plus gas cylinder
<b>Power:</b>	400W
<b>Voltage:</b>	220-240V 50Hz
<b>Current:</b>	2.3A
<b>Working Temperature:</b>	0 to 10°C
<b>Ambient Temperature:</b>	43°C
<b>Climate Class:</b>	SN-T
<b>Refrigerant:</b>	R600a (120g)
<b>Insulation Gas:</b>	Cyclopentane



*Taps and Font not included*

## Schematics

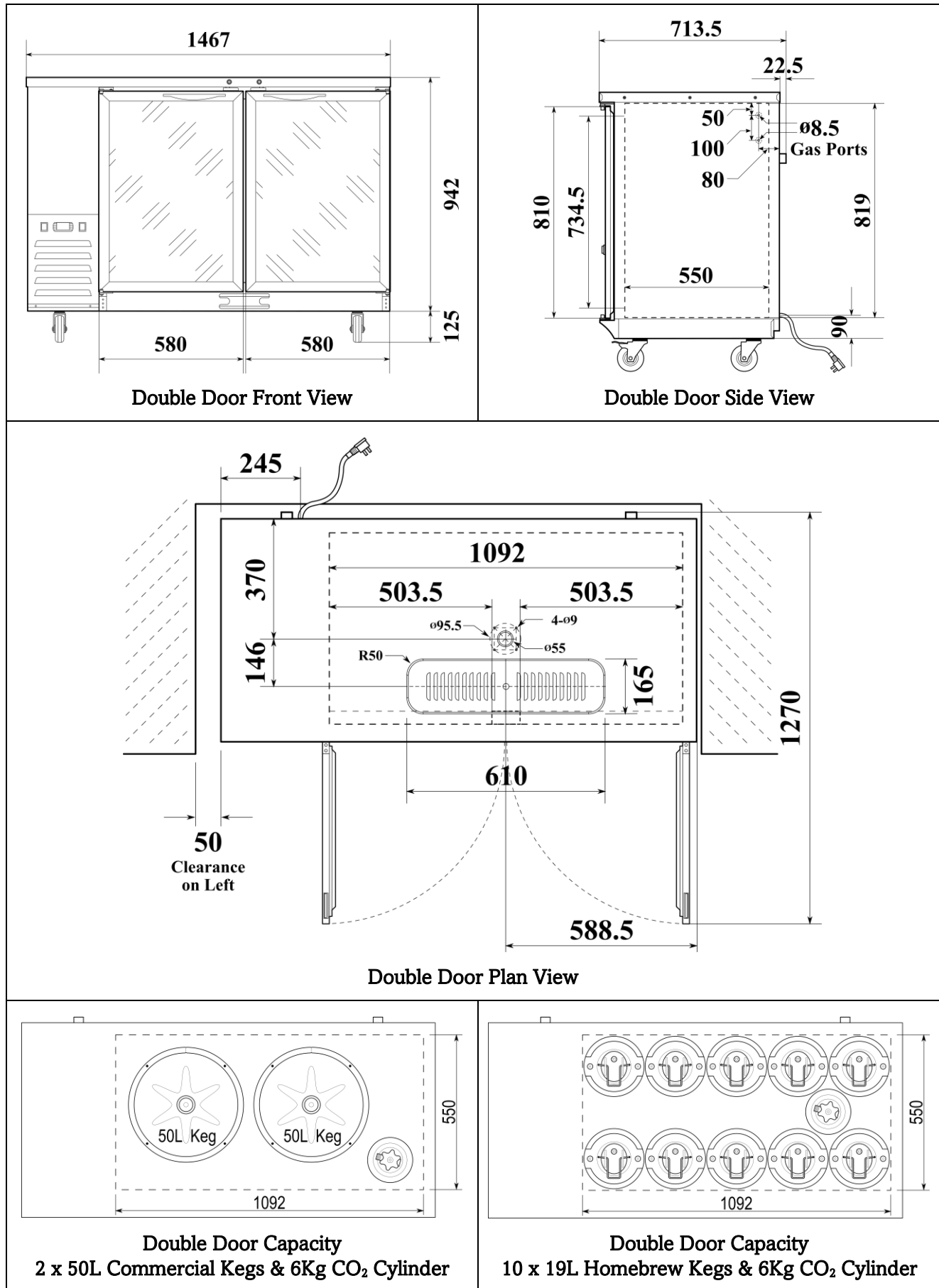

## Super Deluxe Double Door XL - Model 7715

### Model Specific Features

- Two countertop font ports for optional tap fonts
- Two stainless recessed drip trays with drainage
- Mountings for optional shelves (e.g. for packaged beverages)
- Interior lighting

### Specifications

<b>Packing Dimensions:</b>	Width: 1830 mm Depth: 765 mm Height: 1150 mm, Weight: 120 Kg
<b>External Dimensions:</b>	Width: 1727 mm Depth: 713.5 mm, 1270 mm with doors open Height: 942 mm, 1067 mm including castors
<b>Internal Dimensions:</b>	Width: 1352 mm Depth: 550 mm Height: 819 mm
<b>Weight:</b>	115 Kg
<b>Capacity:</b>	600 L 3 x 50L kegs (commercial) or 13 x 19L kegs (homebrew) plus gas cylinder
<b>Power:</b>	400W
<b>Voltage:</b>	220-240V 50Hz
<b>Current:</b>	2.3A
<b>Working Temperature:</b>	0 to 10°C
<b>Ambient Temperature:</b>	43°C
<b>Climate Class:</b>	SN-T
<b>Refrigerant:</b>	R600a (120g)
<b>Insulation Gas:</b>	Cyclopentane



*Taps and Fonts not included*

## Schematics

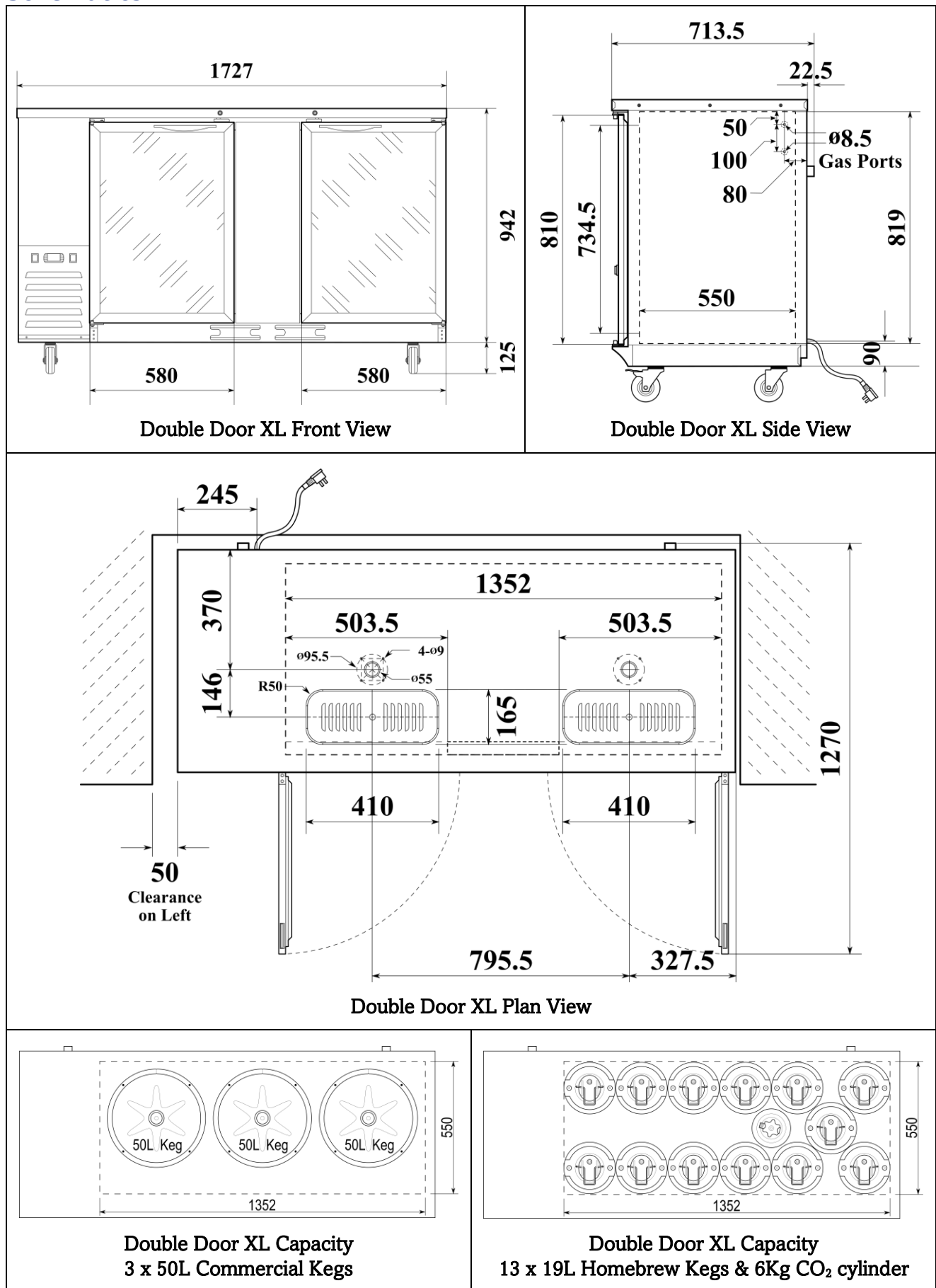

## Super Deluxe Triple Door – Model 7716

### Features:

- Heavy duty Embraco compressor with environmentally friendly R290 refrigerant
- Two countertop font ports for optional tap fonts
- Two stainless recessed drip trays with drainage
- Mountings for optional shelves (e.g. for packaged beverages)
- Interior lighting

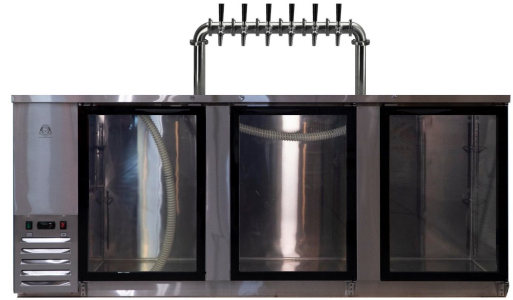

### Specifications

<b>Packing Dimensions:</b>	Width: 2329 mm Depth: 765 mm Height: 1150 mm, Weight: 162 Kg
<b>External Dimensions:</b>	Width: 2267 mm Depth: 713.5 mm, 1270 mm with doors open Height: 942 mm, 1067 mm including castors
<b>Internal Dimensions:</b>	Width: 1892 mm Depth: 550 mm Height: 819 mm
<b>Weight:</b>	128 Kg
<b>Capacity:</b>	850 L 4 x 50L kegs (commercial) plus gas cylinder 16 x 19L kegs (homebrew) plus gas cylinder
<b>Power:</b>	450
<b>Voltage:</b>	220-240V 50Hz
<b>Current:</b>	2.5A
<b>Working Temperature:</b>	0 to 10°C
<b>Ambient Temperature:</b>	43°C
<b>Climate Class:</b>	SN-T
<b>Refrigerant:</b>	R290 (120g)
<b>Insulation Gas:</b>	Cyclopentane

*Taps and Fonts not included*



## Schematics

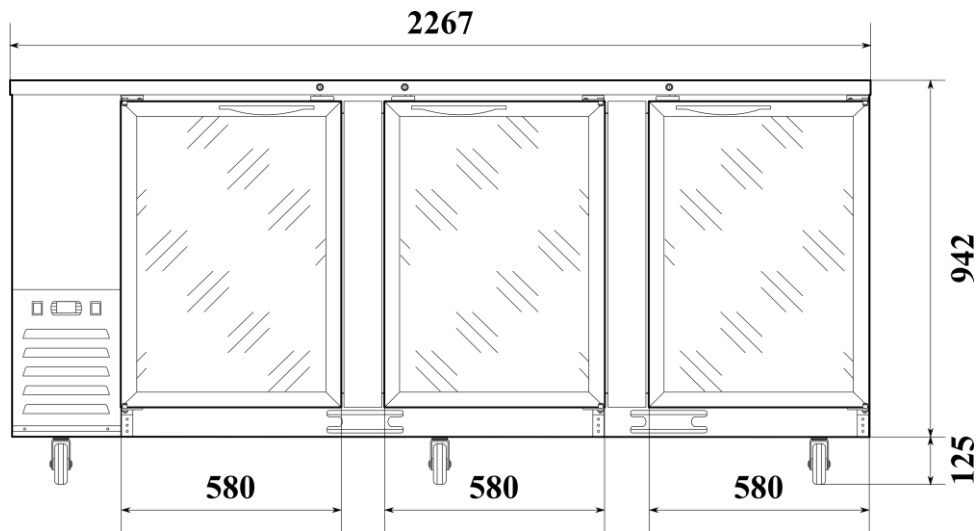

### Triple Door Front View

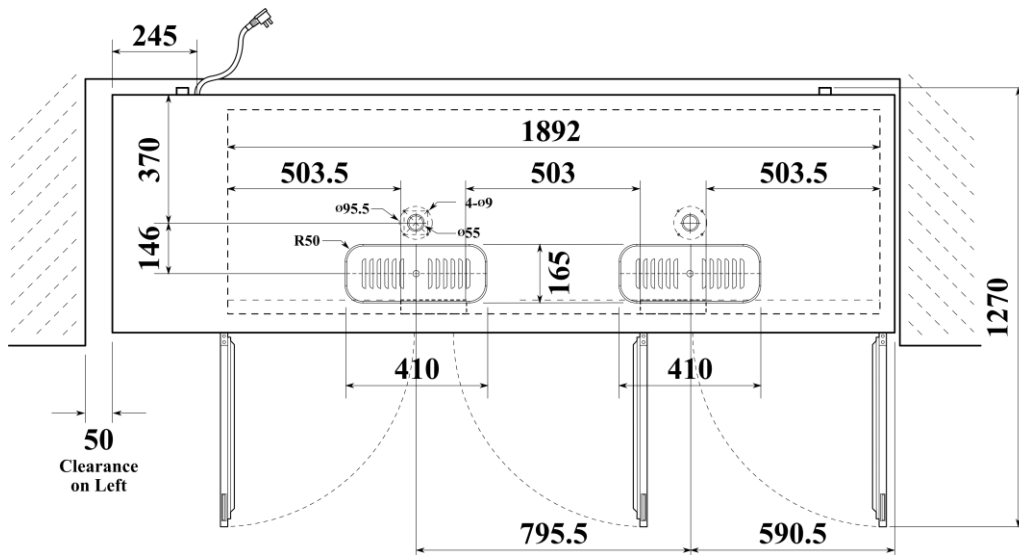

### Triple Door Plan View

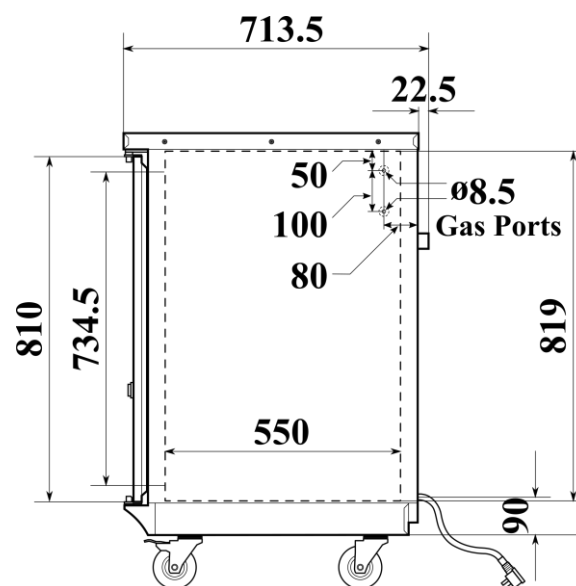

### Triple Door Side View

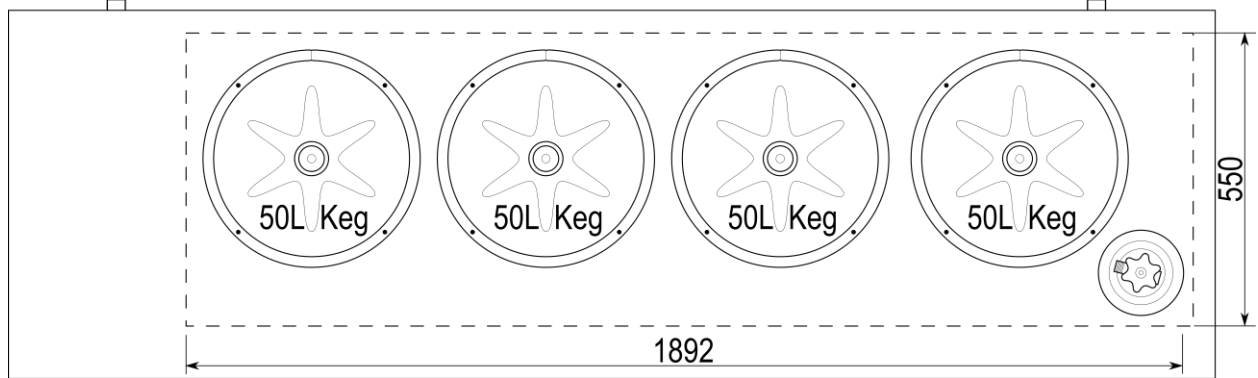

**Triple Door Capacity: 4 x 50L Commercial Kegs & 6Kg CO<sub>2</sub> Cylinder**

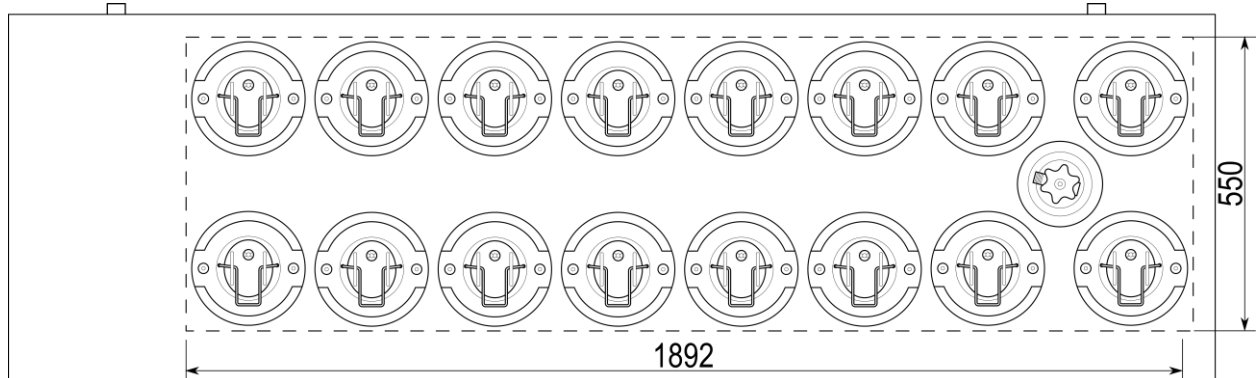

**Triple Door Capacity: 16 x 19L Homebrew Kegs & 6Kg CO<sub>2</sub> Cylinder**

## Optional Items

### Modular Font Kits

The Super Deluxe range of refrigeration units work well with Keg King's modular font kits. Available in 1, 2, 3, 4, 5 and 6 tap kits.



Our modular font sets provide a fantastic looking, professional finish to any bar or beverage sales location. Perfect for mounting on our Super Deluxe series of professional grade under-bar fridges.

The fonts are constructed from 304 Stainless Steel and manufactured to be assembled with 2-inch tri-clover fittings. This variety of font does not utilize shank attachments for the taps. It is designed to work with our 3/4-inch Kinglok fittings that provide users the ability to disconnect their taps quickly and easily for maintenance or cleaning.

These Modular Font Kits come with everything you need to set up a font with taps, including (depending on font kit)

UltraTap faucets

6mm Stainless Steel Elbow barbtails

Modular Font 2-inch Tri-Clover Stand Pipes

Modular Font 2-inch Tri-Clover Elbows and/or Extensions depending on font kit

2-inch Tri-Clover Clamps

2-inch Tri Clover Silicone O-rings Beaded Seal Double Sided

2-inch Tri Clover End Caps (no hole)

KingLok Female x 3/4 Male Font Adaptors

SL6 washers

Kinglok Male x Tap Shank Adaptors

Beer Line

Premium Black Liquid Disconnects

Premium Grey Gas Disconnects

## Schematics

